

NO	DESCRIPTION	DATE
1	($\phi 5.3$) $\rightarrow \phi 5.5$ $\phi 2.3^{+0.1}_{-0.05} \rightarrow \phi 2.30$ DEL $\phi 7.5$	09.28.06'
2	BACKGROUND FORMAT UPDATED	03.10.09'

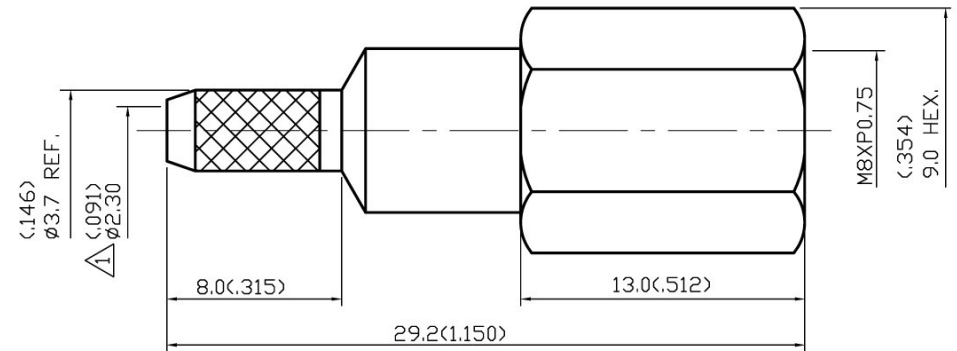
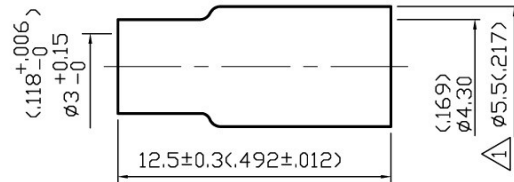

1.0 ELECTRICAL

- 1.1 FREQUENCY RANGE: DC-1.8 GHz
1.2 NOMINAL IMPEDANCE: 50 OHM

2.0 MATERIALS

- 2.1 BODIES: BRASS PER JIS-C3604
2.2 CENTER CONTACT: BRASS PER JIS-C3604
2.3 INSULATION: TEFLON PER ASTM D1457 AND ASTM D1710
2.4 CRIMP FERRULE: BRASS PER JIS-C2700

3.0 FINISHES AND OTHERS

- 3.1 SEE BELOW TABLE FOR DETAILS.

4.0 MECHANICAL

- 4.1 FOR USE WITH RG174U OR SIMILAR STYLE CABLE
4.2 CABLE ATTACHMENT: OUTER: CRIMP, INNER: SOLDER/CRIMP
4.3 CABLE RETENTION 15 lbs MIN.
4.4 CRIMP SIZE REQUIRED: CONTACT: SOLDER/1.8(0.071) HEX. CRIMP TOOL
FERRULE: 3.5(138) HEX. CRIMP TOOL
4.8(189) HEX. CRIMP TOOL

5.0 ENVIRONMENTAL

- 5.1 OPERATING TEMPERATURE RANGE: -55° C TO +125° C

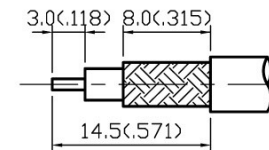
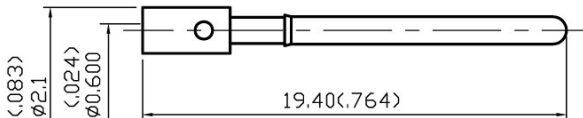

STRIPPING DIMENSION

APPROVED

by _____ DATE: _____

NO	DESCRIPTION	MATERIAL	Q'TY	FINISH
5	INSULATION II	TEFLON	1	NONE
4	BODY	BRASS	1	NICKEL 100μ" MIN.
3	INSULATION I	TEFLON	1	NONE
2	CENTER CONTACT	BRASS	1	GOLD
1	CRIMP FERRULE	BRASS	1	NICKEL

DESCRIPTION			FME STRAIGHT PLUG CRIMP									
製圖	DRAWN	TOLERANCE		品名	23-07	T.G.N	174U	日期	DATE	版次	REV.	
	Yoko	.X	±0.2	TITLE	\ROHS COMPLIANT		(50Ω)	07.06.92		A-2		
檢圖	CHECK	.XX	±0.1	單位	UNIT	DWG.NO. ADA-23070						
	Jockey				mm(in)							
認定	APPROVAL	.XXX	±0.05	比例	SCALE	ADACTUS						
	Lewis	ANGLE	±5°		4:1							

ADASTUS